

HIGH TEMPERATURE PLUGS



TEMPERATURE RANGE - CERAMIC TIPPED 0 TO 450 °C
SILICON RUBBER 0 TO 250 °C

CURRENT AMP RATING - CERAMIC TIPPED 380V 25 AMP
SILICON RUBBER 240V 16 AMP

CATALOGUE #	MAX. AMPERAGE	MAX. TEMPERATURE	CONFIGURATION
HTS 1	25	450 °C	STRAIGHT
HTS 2	25	450 °C	RIGHT ANGLE
HTS 5	16	250 °C	STRAIGHT
HTS 6	16	250 °C	RIGHT ANGLE

THERMOSTATS

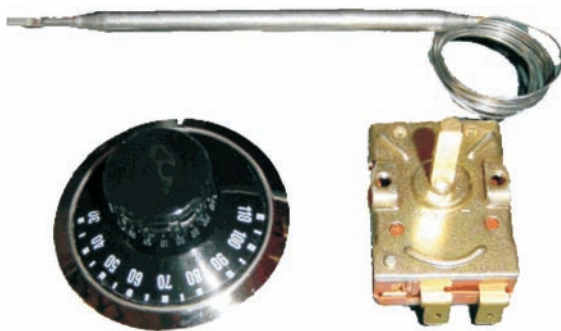

APPLICATION - AMBIENT, BOILERS, WASHING MACHINES, FRYERS, OVENS AND WARMERS.

RATING - 16A / 400V TERMINATION - DIN 46244 - 6.3 x 0.8MM

TEMPERATURE RANGE - BODY T85 / T150 °C

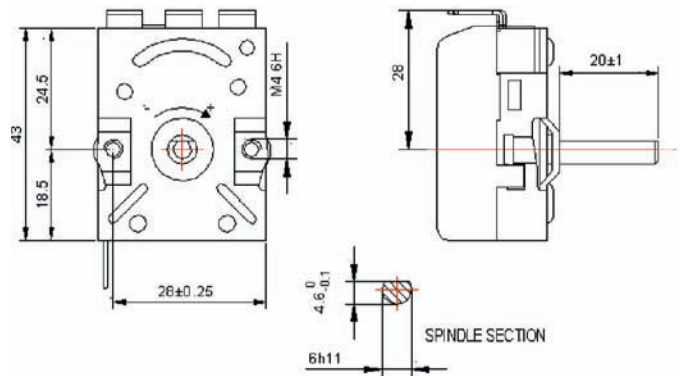

MODELS AVAILABLE:

- ADJUSTABLE
- ADJUSTABLE - WITHOUT SPINDLE
- ADJUSTABLE - THREE PHASE
- FIXED TEMPERATURE - AUTO RESET
- FIXED TEMPERATURE - MANUAL RESET

TEMPERATURE RANGE AVAILABLE (OTHERS ON REQUEST)			
0 - 40 °C	0 - 85 °C	30 - 93 °C	30 - 110 °C
60 - 200 °C	50 - 250 °C	50 - 300 °C	

HIGH TEMPERATURE GLASS CABLE



APPLICATION - DIRECT HEATER ELEMENT WIRING TO PLATENS, BARRELS, MOULDERS AND EXTRUDERS.

CONSTRUCTION - THE HIGHEST QUALITY MULTI STRAND PURE NICKEL CONDUCTORS, DOUBLE GLASS INSULATED WRAPPED AND WOVEN, SILICONE BONDED. SINGLE AND 3 CORE.

TEMPERATURE RANGE - 0 TO 450 °C

STRANDING	SECTIONAL MM ²	AMPERAGE
16 / 0.20 MM	0.50 MM ²	2.0
24 / 0.20 MM	0.75 MM ²	4.5
32 / 0.20 MM	1.00 MM ²	6.0
30 / 0.25 MM	1.50 MM ²	9.0
50 / 0.25 MM	2.50 MM ²	12.0
56 / 0.30 MM	4.00 MM ²	15.0

MANUFACTURING PLANTS

MELBOURNE TEL: (03) 9556 0222
SYDNEY TEL: (02) 9638 7055

ADELAIDE TEL: (08) 8445 1477
PERTH TEL: (08) 6278 4008

BRISBANE TEL: (07) 3341 5222
Web: www.helios.com.au