

## CAST-IN HEATERS

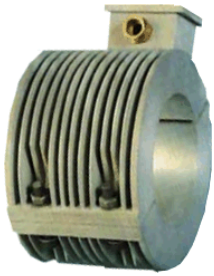

**APPLICATION** - HIGH TEMPERATURE PLASTICS EXTRUSION BARRELS, INJECTION MOULDERS, HEAT SEALERS, HOT PLATES, DIES ECT.

**CONSTRUCTION** - TUBULAR HEATING ELEMENT CAST-IN EITHER ALUMINIUM, BRONZE, BRASS OR IRON. WATER COOLING CAN BE ADDED

**VERSATILITY** - IN DESIGN, MINIMUM MACHINING ON UNUSUAL SHAPED APPLICATIONS.

**TEMPERATURE RANGE** - ALUMINIUM 0 TO 500 °C, BRONZE OR IRON 0 TO 750 °C



DESIGN PARAMETERS	MINIMUM	MAXIMUM
DIAMETER MM	50	750
WIDTH MM	25	750
VOLTAGE	110	440
WATT DENSITY	25 kW/M2	45 kW/M2

## TUBULAR BAND HEATERS



**APPLICATION** - DESIGNED TO WITHSTAND DIFFICULT CONDITIONS SUCH AS VIBRATIONS AND CORROSION, THEY ARE MANUFACTURED ACCORDING TO YOUR REQUIREMENTS. HIGH TEMPERATURE PLASTICS EXTRUSION BARRELS, INJECTION MOULDERS, HEAT SEALERS, HOT PLATES, DIES ETC.

**CONSTRUCTION** - A STAINLESS STEEL TUBULAR ELEMENT IS COILED INTO A CYLINDRICAL SHAPE AND INSERTED INTO A METAL RING CLAMP. SWIVEL CLAMPING AND HTS PLUG BASE FITTED

**VERSATILITY** - TUBULAR HEATERS ARE ADAPTABLE TO A WIDE VARIETY OF INDUSTRIAL APPLICATIONS. THEY CAN BE FORMED INTO ANY DESIRED SHAPE.

**TEMPERATURE RANGE** - 0 TO 750 °C

DESIGN PARAMETERS	MINIMUM	MAXIMUM
DIAMETER MM	50	750
WIDTH MM	25	500
VOLTAGE	110	440
WATT DENSITY	25 kW/M2	75 kW/M2

## METAL SHEATH MICA INSULATED STRIP HEATERS



**APPLICATION** - CLAMP-ON PLATENS, DIES, MOULD, TANKS, SEALING AND PACKAGING MACHINERY, PLASTIC AND RUBBER MOULDING MACHINERY

**CONSTRUCTION** - MICA INSULATED METAL SHEATH HEATER SIZED TO YOUR APPLICATION. TERMINATION LEADS, SCREW OR JUNCTION BOX AS REQUIRED.

**VERSATILITY** - COMPACT THIN AND LIGHT WEIGHT HEAT SOURCE FOR FAST HEAT TRANSFER AND MAXIMUM EFFICIENCY.

**TEMPERATURE RANGE** - 0 TO 300 °C



DESIGN PARAMETERS	MINIMUM	MAXIMUM
LENGTH MM	38	2000
WIDTH MM	38	1000
VOLTAGE	110	440
WATT DENSITY	5 kW/M2	45 kW/M2

### MANUFACTURING PLANTS

MELBOURNE TEL: (03) 9556 0222  
SYDNEY TEL: (02) 9638 7055

ADELAIDE TEL: (08) 8445 1477  
PERTH TEL: (08) 6278 4008

BRISBANE TEL: (07) 3341 5222  
Web: [www.helios.com.au](http://www.helios.com.au)