

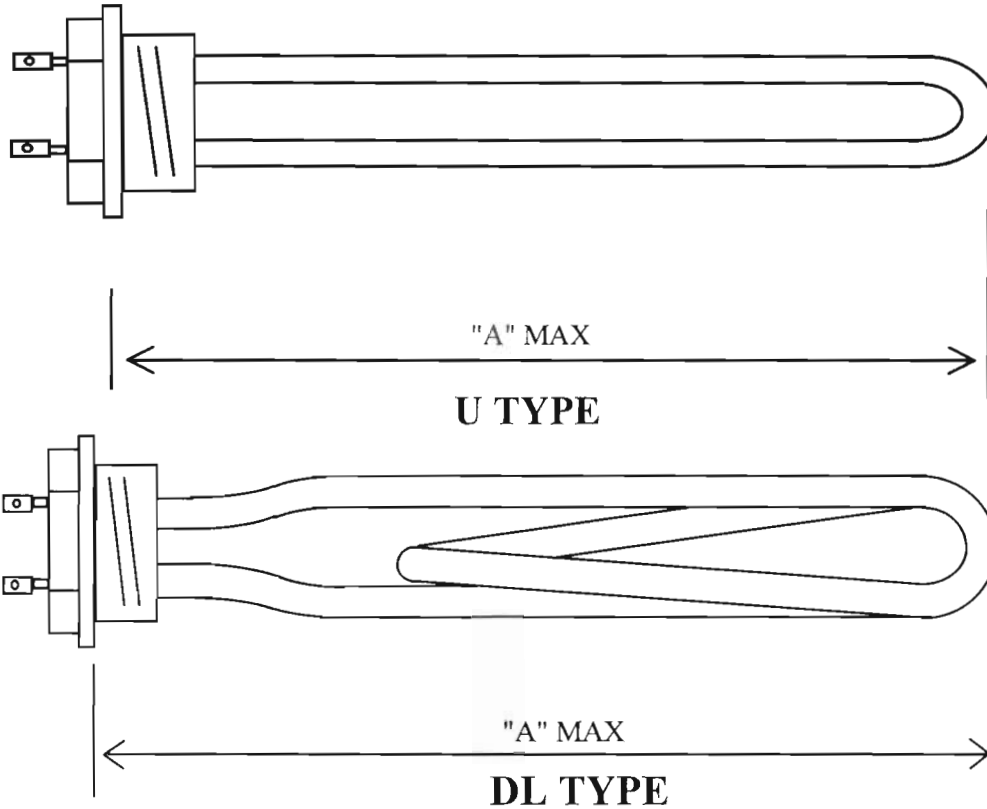

# 1 1/4" BSP WATER HEATING ELEMENTS

## CORROSION RESISTANT ALLOY SHEATHED ELEMENTS

Thread O.D 40mm



PART No.	RATING Watts	"A" MAX mm	TYPE	DESCRIPTION
SM 5	500	230	U	
SM 7	750	245	U	
SM 10	1000	270	U	
SM 12	1200	280	U	
SM 15	1500	305	U	
SM 18	1800	230	DL	
SM 20	2000	245	DL	
SY 22C	2200	153	FB	FOR CAFE' BAR COMPACT SEE PAGE 49
SY 22T	2200	153	FB	FOR CAFE' BAR SEE PAGE 49
SM 24	2400	280	DL	
SM 30	3000	305	DL	
SM 36	3600	305	DL	
SM 48	4800	405	DL	

**SUPPLIED** with fibre gasket (Part no. ZGF 3)



## CORROSION RESISTANT ALLOY SHEATHED ELEMENTS

Thread O.D 40mm

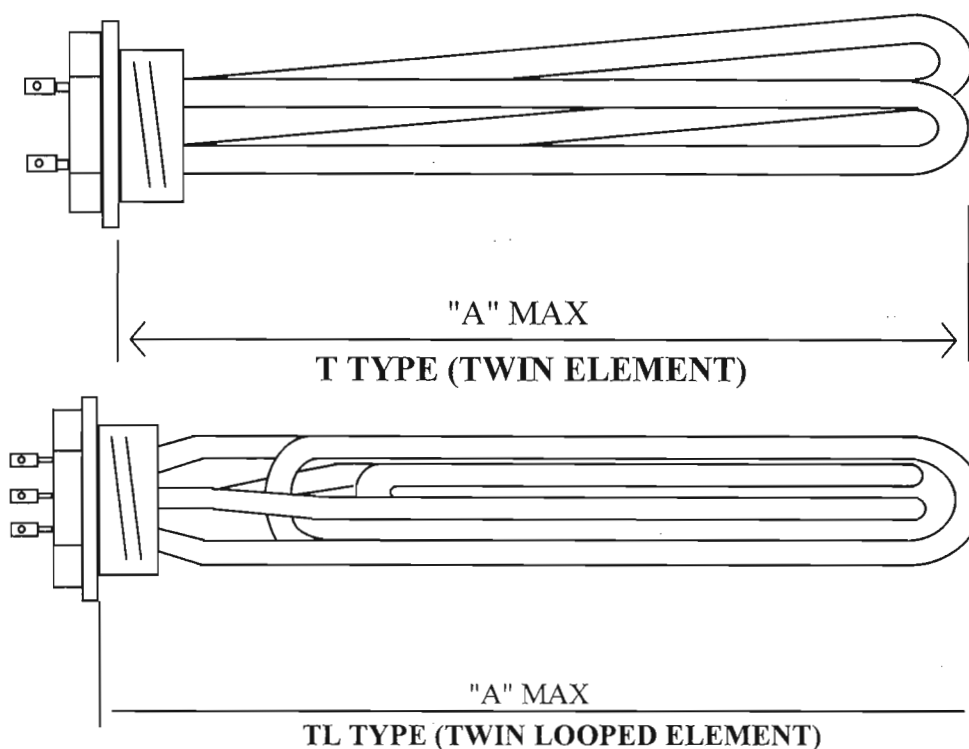

PART No.	RATING Watts	"A" MAX mm	TYPE	
TM 10	1000	230	T	
TM 12	1200	230	T	
TM 15	1500	245	T	
TM 18	1800	255	T	
TM 20	2000	270	T	
TM 24	2400	280	T	
TM 30	3000	305	T	
TM 36	3600	355	T	
TM 40	4000	410	T	
TM 48	4800	460	T	
TM 60	6000	560	T	
TM 60B	6000	305	TL	Spa Pool Heater
TM 72	7200	560	T	
TM 80	8000	560	T	
TM 80B	8000	305	TL	Spa Pool Heater

**SUPPLIED** with fibre gasket (Part no. ZGF 3)



# 1 1/4" BSP OIL HEATING ELEMENTS

Thread O.D 40mm

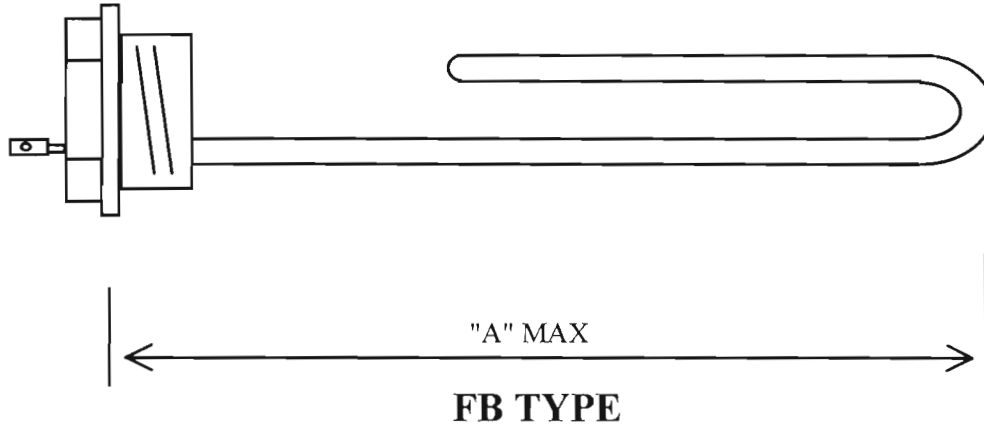

PART No.	RATING Watts	"A" MAX mm	TYPE
SS 5	500	230	FB
SS 7	750	305	FB
SS 10	1000	395	FB
SS 12	1200	460	FB

**PLEASE NOTE:**

The above elements have a surface loading of 32kw /sq m.  
Check with L.N or your oil supplier that this loading is suitable for your particular application.

# 1 1/4" BSP OIL HEATING ELEMENTS



Thread O.D 40mm

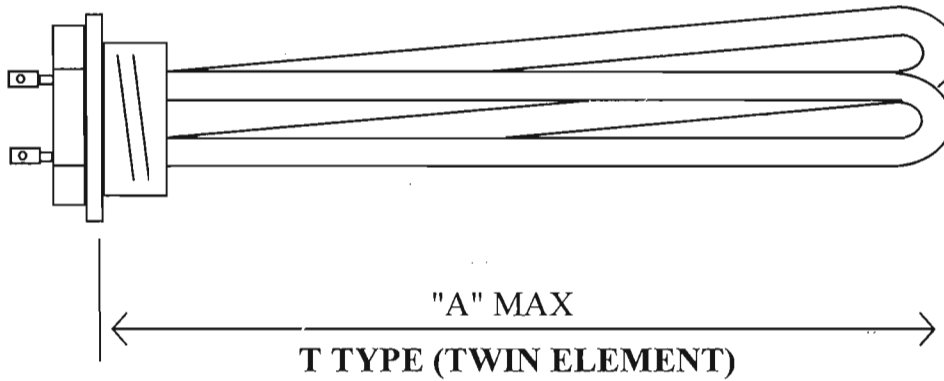

PART No.	RATING Watts	"A" MAX mm	TYPE
TS 15	1500	535	T
TS 20	2000	710	T

## PLEASE NOTE:

The above elements have a surface loading of 32kw /sq m.  
Check with L.N or your oil supplier that this loading is suitable for your particular application.

**SUPPLIED** with fibre gasket (Part no. ZGF 3)



# SPECIAL 1 1/4" BSP ELEMENTS

Thread O.D 40mm

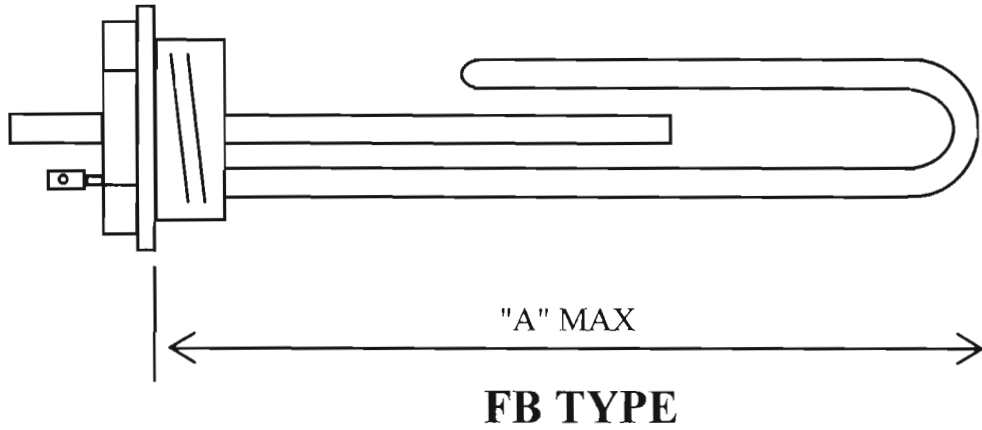

PART No.	RATING Watts	"A" MAX mm	TYPE	DESCRIPTION
SWM 15	1500	305	U	With thermowell
SWM 30	3000	305	U	With thermowell
SY 22T	2200	153	FB	See Page 49
SY 22C	2200	153	FB	See Page 49

**SUPPLIED** with fibre gasket (Part no. ZGF 3)

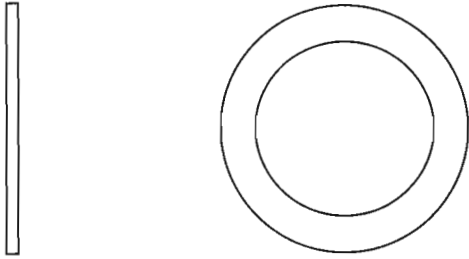

**ZGF 3**  
FIBRE GASKET  
FOR 1.25" BSP BOSS

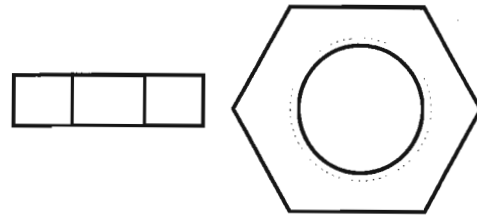

**ZBA 3**  
BRASS NUT  
FOR 1.25" BSP BOSS

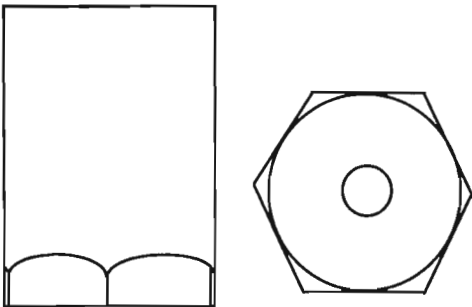

**ZCA 3**  
ALUMINIUM COVER  
FOR 1.25" BSP BOSS



**ELS 3**  
3 WAY SPANNER SUITS 1", 1 1/4" & 2"  
BSP ELEMENTS.

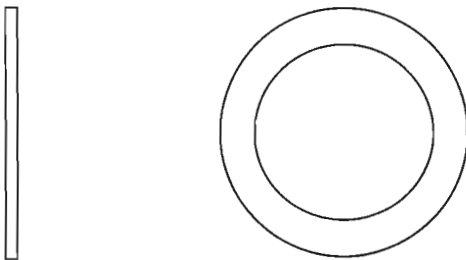

**ZGS 3**  
COPPER GASKET  
FOR 1.25" BSP BOSS